

# DH-PFB303S

## Parapet Mount Bracket



- Made from aluminum alloy and SUS 430.
- Matched with particular cameras, beautiful and elegant designed.



### Series Overview

Dahua Mounting Bracket works with front-end services, supporting installation methods such as wall mount, pole mount, corner mount and in-ceiling mount. Select brackets are designed to suit complex scenes, making them convenient to use in environments with high temperatures, humidity, frequent vibrations, and in locations that are highly corrosive. These highly reliable brackets are easy to install and use.

### Scene

Ideal for mounting cameras, and works in temperatures ranging from  $-40^{\circ}\text{C}$  to  $+60^{\circ}\text{C}$  ( $-40^{\circ}\text{F}$  to  $+140^{\circ}\text{F}$ ) and in environments with a relative humidity of less than 90%.

### Technical Specification

#### Structure

Casing Material	Aluminum alloy, SUS 430
Product Dimensions	878.5 mm $\times$ 824.0 mm $\times$ 180.0 mm (34.59" $\times$ 32.44" $\times$ 7.09") (L $\times$ W $\times$ H)
Appearance Color	White
Net Weight	4.3 kg (9.48 lb)
Gross Weight	6.2 kg (13.67 lb)
Load Bearing	7.0 kg (15.43 lb)
Installation	Parapet mount
Screw Thread Type	G1 1/2
Applicable Model	Please see "Camera Accessories Selection"
Packaging Dimensions	1,290.0 mm $\times$ 160.0 mm $\times$ 510.0 mm (50.79" $\times$ 6.30" $\times$ 20.08") (L $\times$ W $\times$ H)

### Environment

Operating Temperature	$-40^{\circ}\text{C}$ to $+60^{\circ}\text{C}$ ( $-40^{\circ}\text{F}$ to $+140^{\circ}\text{F}$ )
Operating Humidity	<90% (RH)
Storage Temperature	$-40^{\circ}\text{C}$ to $+60^{\circ}\text{C}$ ( $-40^{\circ}\text{F}$ to $+140^{\circ}\text{F}$ )
Storage Humidity	10%–90% (RH)
Anti-corrosion Level	Basic Protection

### Ordering Information

Type	Model	Description
Camera Mount	DH-PFB303S	Parapet Mount Bracket

### Installation

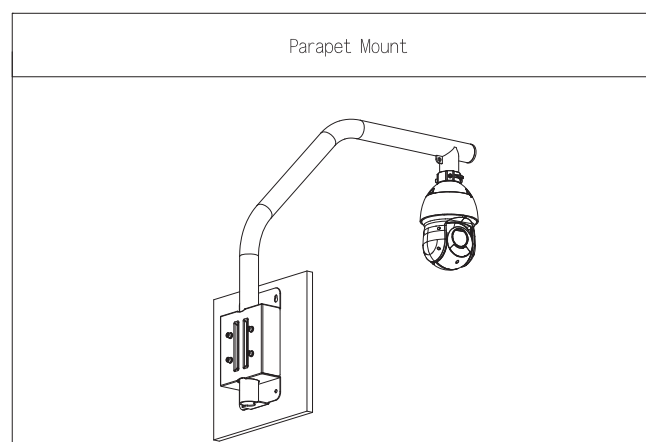

## Dimensions (mm[inch])

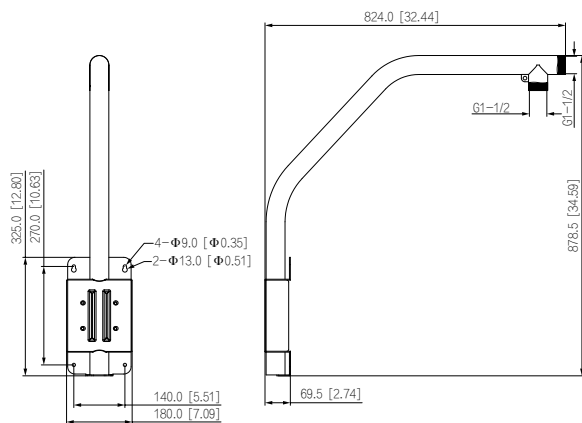

## Package Information

- Parapet mount bracket × 1
- ST8×80 screw × 4
- S6.0 wrench × 1
- Safety rope × 1